

FACILITY MAP

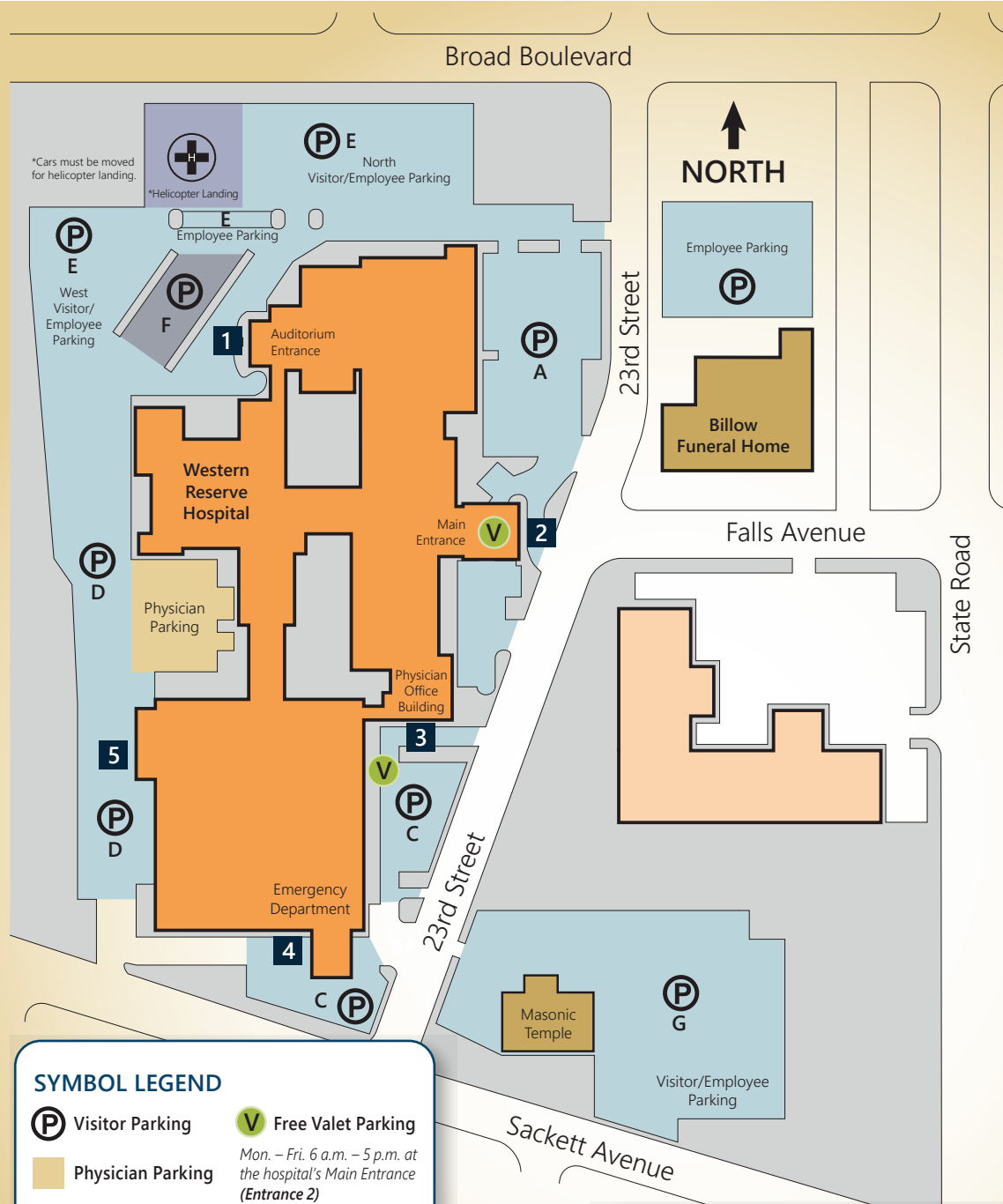

ENTRANCE LEGEND

1 Entrance 1

- Auditorium
- Medical Education
- Suites 1100 & 1200

2 Entrance 2

- Cardiac Catheterization Lab
- General and Bariatric Surgery
- Main Lobby
- New Choice Pharmacy
- Outpatient Surgery
- Patient Rooms
- Sleep Medicine Center
- Surgery
- Valet 6 a.m. - 5 p.m. (Mon. - Fri.)
- Visitor Entrance

3 Entrance 3

- Center for Pain Medicine
- Endoscopy
- ICU
- Occupational Medicine
- Physical Therapy
- Physician Office Building
- Suites 303 - 404
- Valet 6:45 a.m. - 5 p.m. (Mon. - Fri.)

4 Entrance 4

- Emergency Department
- Infusion

5 Entrance 5

- Anticoagulation Clinic
- Cardiopulmonary
- Laboratory
- Nuclear Medicine
- Outpatient Registration
- Pre-Surgical Testing
- Radiology
- Suite 1000
- Women's Imaging Center
- Wound Care Clinic

SYMBOL LEGEND

- (P)** Visitor Parking
- (V)** Free Valet Parking
Mon. - Fri. 6 a.m. - 5 p.m. at the hospital's Main Entrance (Entrance 2)
Mon. - Fri. 6:45 a.m. - 5 p.m. (Entrance 3)
- Physician Parking**
- Patient Parking**
- Visitor Entrances**

PHONE NUMBERS

General Information (330) 971-7000
 Patient Information..... (330) 971-7410
 Emergency Department.....(330) 971-7436
 Security (for directions) (330) 971-7412
 Valet..... #2277

VISITING HOURS

Our hospital has open visiting hours. Please use the main entrance. For guests visiting after posted visiting hours, please enter through the Emergency Department entrance.



DRIVING DIRECTIONS

Western Reserve Hospital 1900 23rd Street Cuyahoga Falls, OH 44223

DRIVING DIRECTIONS:

From the North: Take Route 8 South to the Broad Boulevard exit. Turn right onto Broad Boulevard. Go through the State Road intersection. Turn left onto 23rd Street.

From the East: Take I-76 West to Route 8 North. Exit at Broad Boulevard exit. Turn left onto Broad Boulevard. Go through the State Road intersection. Turn left onto 23rd Street.

From the West: Take I-77 South. Approaching Akron, I-77 and I-76 merge. Take Route 8 North to the Broad Boulevard exit. Turn left onto Broad Boulevard. Go through the State Road intersection. Turn left onto 23rd Street.

From the Southwest: Take State Route 224/I-76 East. Follow to I-76 East/I-77 South towards Akron. Turn left onto Route 8 North exit. Exit at Broad Boulevard. Turn left onto Broad Boulevard. Go through the State Road intersection. Turn left onto 23rd Street.

From the South: Take I-77 North to Route 8 North. Exit at Broad Boulevard. Turn left onto Broad Boulevard. Go through the State Road intersection. Turn left onto 23rd Street.

Free valet parking:

- Mon. – Fri. 6 a.m. – 5 p.m. at the hospital's Main Entrance (Entrance 2)
- Mon. – Fri., 6:45 a.m. – 5 p.m. at Entrance 3

